

NOTICE OF PROPRIETARY RIGHTS THIS DOCUMENT CONTAINS CONFIDENTIAL TECHNICAL DATA, INCLUDING TRADE SECRETS, PROPRIETARY TO TIMES MICROWAVE SYSTEMS. DISCLOSURE OF THIS DATA IS EXPRESSLY CONDITIONED UPON YOUR ASSENT THAT ITS USE IS LIMITED TO USE WITHIN YOUR COMPANY ONLY. ANY OTHER USE IS STRICTLY PROHIBITED WITHOUT THE PRIOR WRITTEN CONSENT OF TIMES MICROWAVE SYSTEMS.

SYM	REVISION DESCRIPTION	DFTM	DATE	APPD	DATE
A	RELEASED FOR PRODUCTION	J.C.L	11/19/97	J.C.L	11/19/97
B	CHANGED PER CDC #42631	N.N.N	8/18/15	J.D.B	9/3/15
C	CHANGED PER CDC #42879	N.N.N	9/23/15	J.D.B	9/23/15

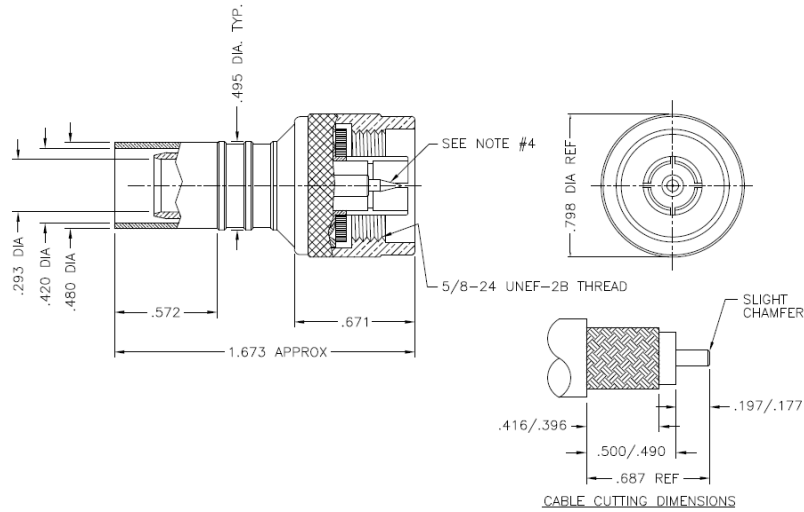

NOTES:

- ASSEMBLED CONNECTOR INTERFACE IS DESIGNED IN ACCORDANCE WITH MIL-STD-348.
- MATERIAL: BODY & COUPLING NUT- BRASS PER ASTM B16
 LOCKING RING - PHOSPHOR BRONZE PER QQ-B-750
 CONTACT - BERYLLIUM COPPER PER ASTM B196.
 GASKET - SILICONE RUBBER PER ZZ-R-765
 INSULATOR - TEFLON PER ASTM D1710
 SHRINK SLEEVE (NOT SHOWN) - HEAT SHRINKABLE ATUM PER MIL-I-23053/4
 CRIMP SLEEVE - D.H.P. COPPER CDA ALLOY 122
- FINISHES: BODY, COUPLING NUT - ALBALOY PLATE
 CONTACT - GOLD PLATE PER MIL-G-45204
 CRIMP SLEEVE - SILVER PLATE PER QQ-S-365
- CONTACT PRE-INSTALLED IN CONNECTOR - HAS SLOTTED SPRING FINGER TO ACCEPT .108 DIA WIRE.

MATERIAL:	UNLESS OTHERWISE SPECIFIED	DFTM. JCL	TIMES MICROWAVE SYSTEMS		
	ALL DIMENSIONS ARE IN INCHES MACHINED SURFACES FINISH 63 RMS MAX. REMOVE ALL BURRS .005 MAX. BREAK MACHINE CORNERS .005 MAX. FILLET R. TOLERANCES ON DECIMALS .XX ± .02 .XXX ± .005 ANGLES ± 1/2° FRACTIONS ± 1/64	DATE 11/19/97			
USED ON:	-	CHKD. JCL	EZ-400-NMK-D CONNECTOR, "N" MALE FOR LMR-400 CABLE		
SCALE: ~	DWG. SIZE A	DATE 11/19/97			
DO NOT SCALE DRAWING	CODE IDENT 68999	DATE 11/19/97	SHEET 1 of 1	SD3190-661	REV C